

Single-ended twin-tee – assembly guide.

The PCB and connectors fit exactly in a small enclosure with inner length of 50mm. A suitable box that I used can be found at eBay:

<https://www.benl.ebay.be/itm/Extruded-PCB-Aluminum-Box-Black-Enclosure-Electronic-Project-Case-DIY-50-25-25mm/192194980520?ssPageName=STRK%3AMEBIDX%3AIT&trksid=p2057872.m2749.l2649>

You need to drill the holes for the BNC connectors off-center as shown below:

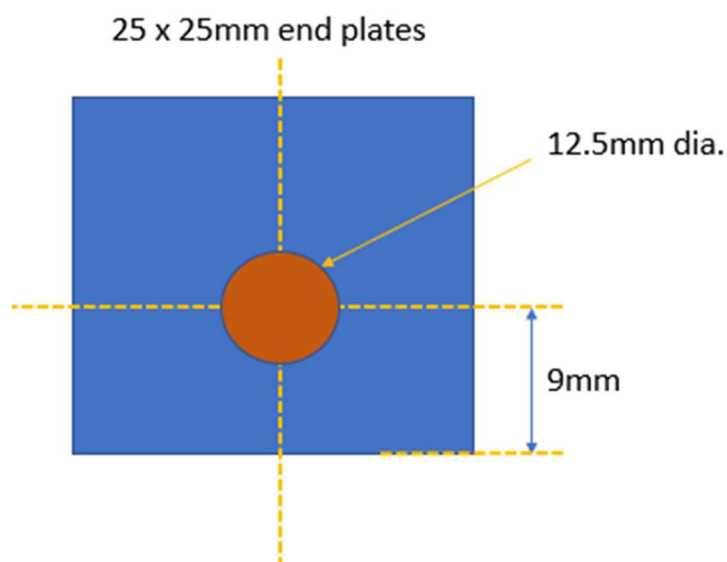

When assembling the unit, use unpainted countersunk screws instead of the painted screws that come with the enclosure, and, using a drill, manually remove the paint on the countersunk holes in the end caps. That will ensure good screening and ground contacts.